3.80L x 3.80W x 1.50H (mm)

Wi2Wi's SAW Filters are available over a wide range of frequencies and are custom designed/fabricated to meet a wide range of requirements. Their high Quality Factor ("Q") fosters sharp cutoff characteristics, low loss, good inter-modulation and tight stability over wide temperature ranges.

Parameter	Symbol	Conditions	Min	Typ	Max	Unit
Center Frequency	Fc			1090		MHz
Insertion Loss		@ 1075 MHz to 1105 MHz		2.3	3.0	dB
Amplitude Ripple		@ 1085 MHz to 1095 MHz		0.25	0.5	dB
Attenuation (Reference level from 0 dB)		DC to 970 MHz	25.0	30.0		dB
		1150 MHz to 1300 MHz	25.0	33.5		dB
VSWR		@ 1075 MHz to 1105 MHz		1.8	2.1	
Operating Temperature			-40		+85	°C
Storage Temperature			-55		+85	°C
Input Power Level					20.0	dBm
DC Voltage					0	Vdc
Terminating Impedance		In/Out		50		Ω

Date	Description	FOR PRELIMINARY USE ONLY		
		Specifications subject to change.		
		SAW Filter		
		PART #: FTR-81061	81061-fts	
		DATE: 7-18-2025	DRAWN BY: B. Arnold	
		CAGE CODE: 0S4G1	SCALE: NTS	PAGE: 1 of 2

FTR-81061

wizwi

Wireless 2 Wireless

PACKAGE DIMENSIONS

Tolerance: ± 0.005 [.13mm] (Unless otherwise specified)

PIN	CONNECTION
2	Input
5	Output
1,3,4,6	Ground

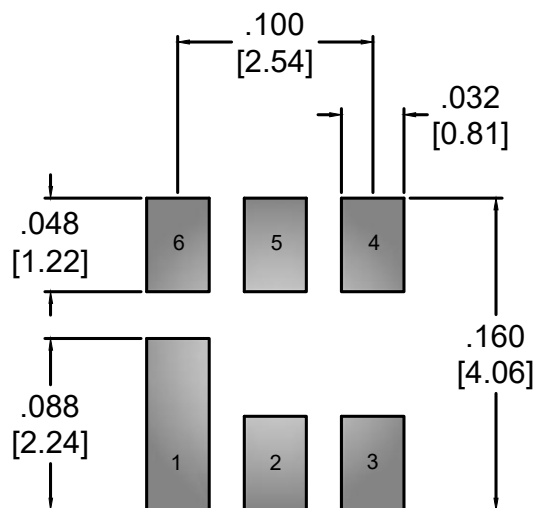
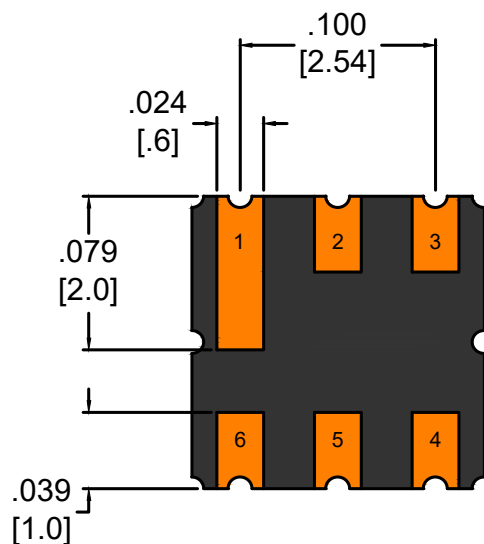
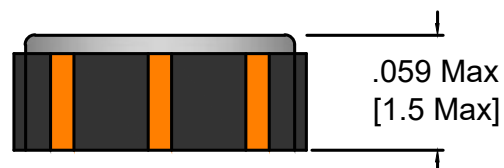
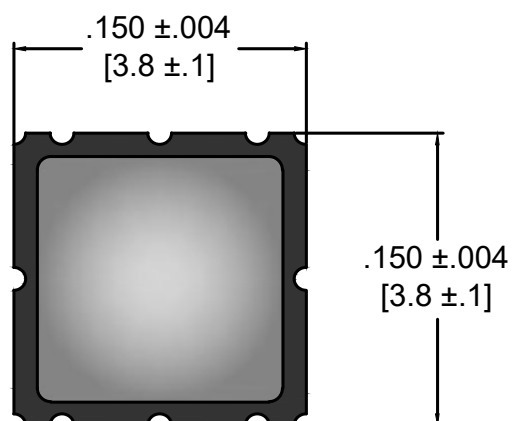

Recommended Land Pattern
(Top View)